

## ST155 Large-Diaphragm Condenser Microphone

## OWNER'S MANUAL

### PRODUCT SPECIFICATION

|                                   |                                |
|-----------------------------------|--------------------------------|
| Circuit Type                      | Class A FET                    |
| Polar Pattern                     | Cardioid                       |
| Frequency Response                | 20–20kHz                       |
| Switchable Hi-Pass Filter         | 75Hz, 12dB/octave              |
| Switchable Attenuation Pad        | –10dB                          |
| Maximum SPL                       | 144dB (134dB without pad)      |
| Sensitivity                       | 32mV/Pa                        |
| Equivalent Noise Level A-Weighted | .22dB SPL                      |
| Typical Load Impedance            | >1000 Ω                        |
| Output Source Impedance           | 200 Ω Transformer Isolated     |
| Power Supply                      | +48V Phantom Power Required    |
| Microphone Dimensions             | 7.7" long 1.9" max diameter    |
| Microphone Weight                 | 1.2 lbs.                       |
| Included Accessories              | SM8 Shock Mount, Aluminum Case |

**RECORDING TIPS:** [www.sterlingaudio.net](http://www.sterlingaudio.net)



OR VISIT OUR WEBSITE AT: [STERLINGAUDIO.NET](http://STERLINGAUDIO.NET)

### Sterling Audio

P.O. Box 5111  
Thousand Oaks, CA 91359-5111

1704-16136387

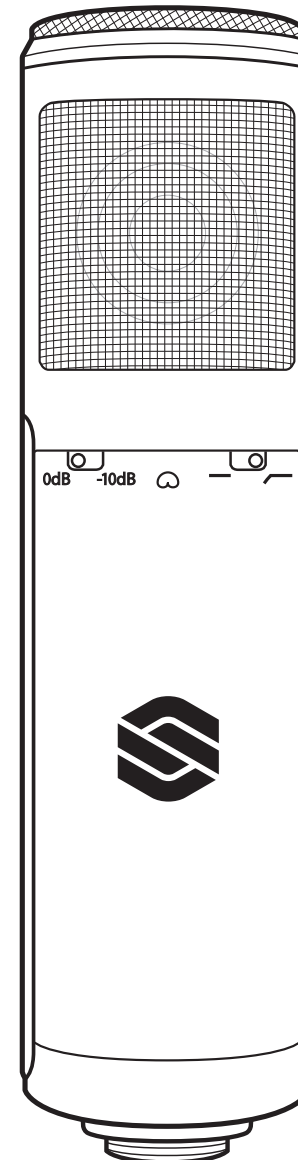

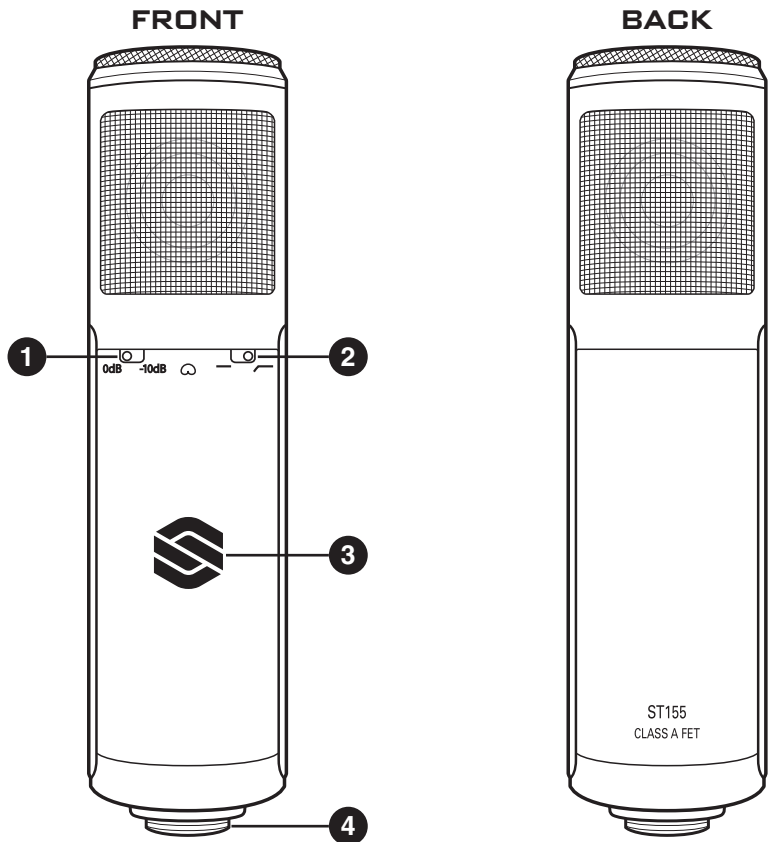

- 1 -10dB Pad**  
Reduces volume: Set to -10dB only if source is too loud for your preamp.
- 2 Low Cut (-12dB/octave @ 75Hz)**  
Reduces very low frequencies: Set to except for bass, kick drum or similar sources.
- 3 Front-address Cardioid**  
Face logo side toward source.
- 4 Audio**  
Connect standard mic cable.

**Phantom Power (48v) Required**

These mics require phantom power from your preamp, audio interface or mixer. Avoid pops: make cable connections first, THEN activate 48v.

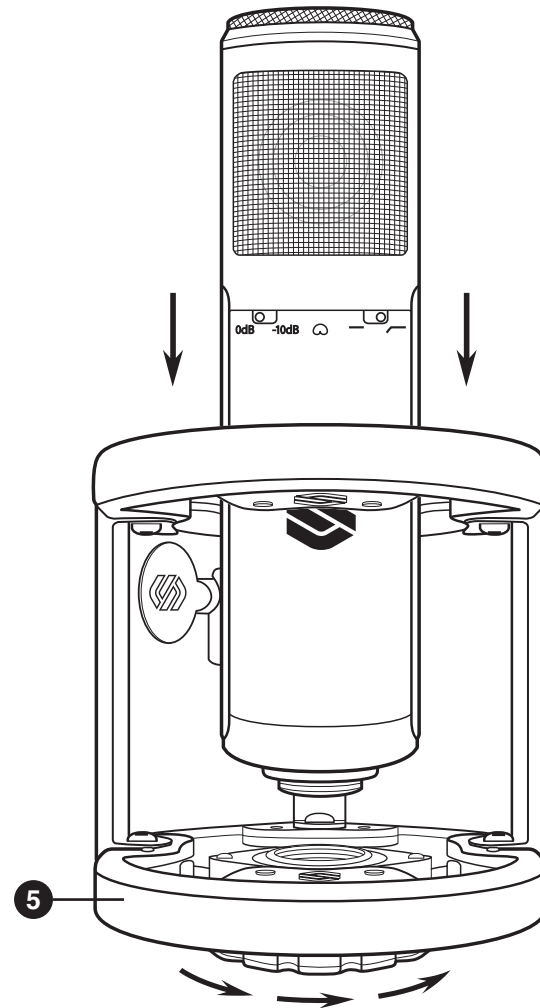

- 5 SM8 Shock Mount**  
Mic end threads into mount: secure mic by spinning dial at bottom of mount until it stops.